

Walraven VibraTek® MS-2X Spring Mount

High performance spring isolator for light equipment

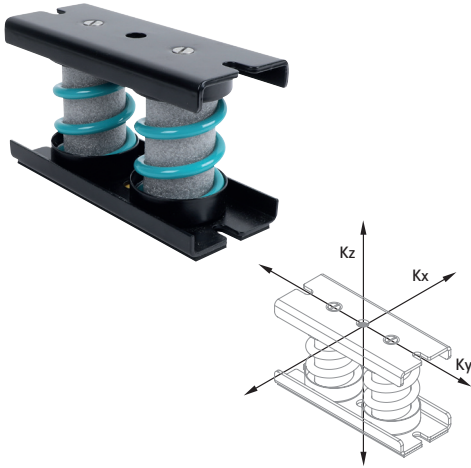

Features and Benefits

- Recommended for equipment with low working speeds, from 600 rpm and above
- Flexible internal filler prevents debris and solid elements entering and damaging the spring under load
- Ribs in the metal base provide increased stiffness
- Slot holes facilitate positioning and anchoring to the base material
- Epoxy powder-coated base, caps and springs provide increased resistance to corrosion
- Ratio $K_x / K_z = 0.98$
- Ratio $K_y / K_z = 1.4$
- Working temperature range -90°C till 150°C

Technical Drawing

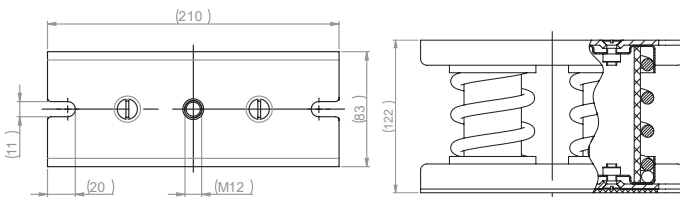

Applications

- Compressors, fans, pumps, chillers, air handling units or other heavy equipment

1. Product and packaging details

Part No.	Description	Dimension	Piece		Pack 1	
			(pcs)	EAN13	(pcs)	EAN13
2802003000	MS-2X Spring Mount	3000/M12	1	8719942054935	5	8719942054942
2802004000	MS-2X Spring Mount	4000/M12	1	8719942054966	5	8719942054973
2802006000	MS-2X Spring Mount	6000/M12	1	8719942054997	5	8719942055000
2802008000	MS-2X Spring Mount	8000/M12	1	8719942055024	5	8719942055031
2802010000	MS-2X Spring Mount	10000/M12	1	8719942055055	5	8719942055062
2802012000	MS-2X Spring Mount	12000/M12	1	8719942055086	5	8719942055093

2. Performance data

Part No.	Description	Dimension	Max. deflection (mm)	Min. load (N)	Max. load (N)	Min. optimal load (N)	Max. optimal load (N)
2802003000	MS-2X Spring Mount	3000/M12	25	300	3000	600	2760
2802004000	MS-2X Spring Mount	4000/M12	25	400	4000	800	3680
2802006000	MS-2X Spring Mount	6000/M12	25	600	6000	1200	5520
2802008000	MS-2X Spring Mount	8000/M12	25	800	8000	1600	7360
2802010000	MS-2X Spring Mount	10000/M12	25	1000	10000	2000	9200
2802012000	MS-2X Spring Mount	12000/M12	25	1200	12000	2400	11040

2.1 Static deflection

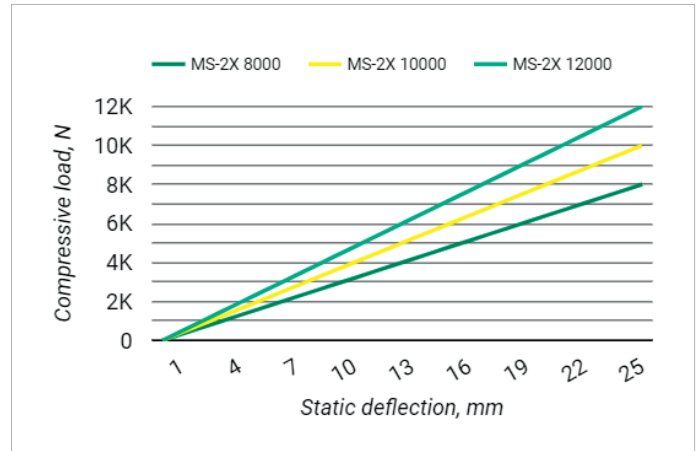
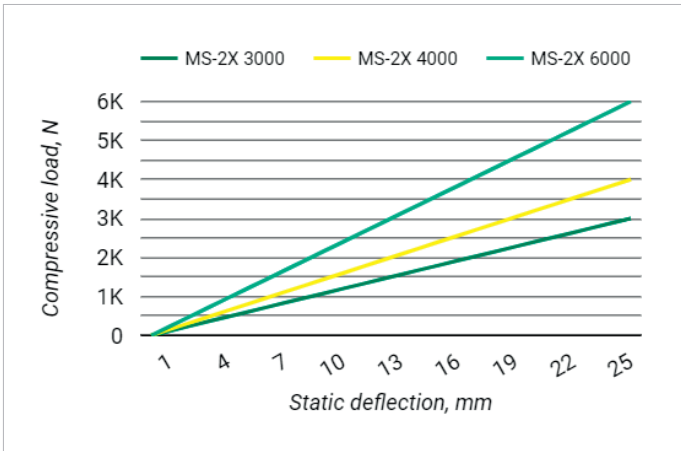

2.2 Isolation efficiency

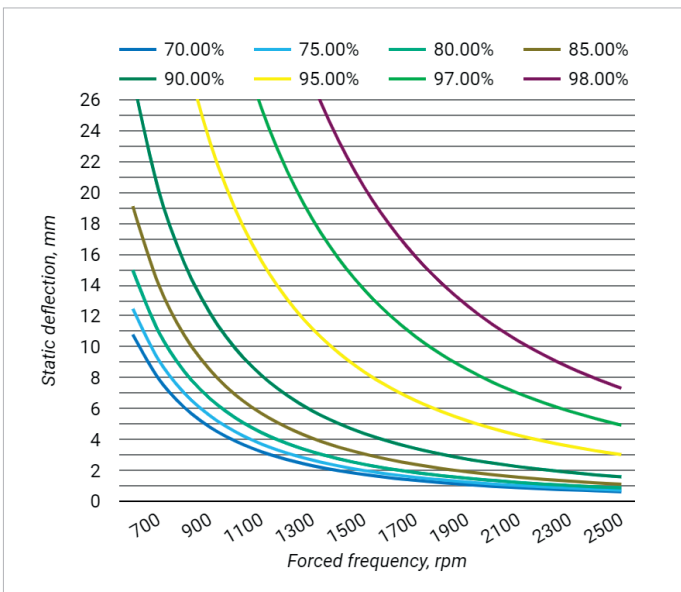

2.3 Natural frequency

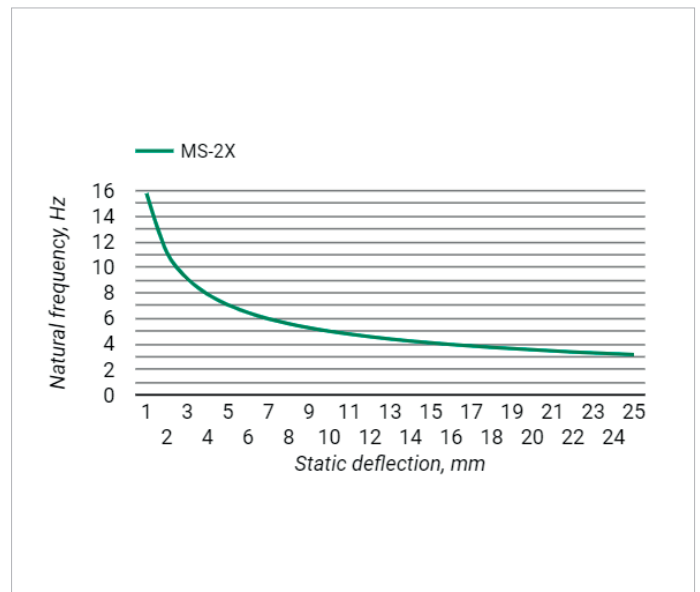

3. Dynamic properties

Description	Value
Damping factor	0.001
Ratio Kx / Kz	0.98
Ratio Ky / Kz	1.4
Maximum transient overload % on maximum load	30 %
Working temperature range	-90 °C till 150 °C

4. Estimation of performance

Part No.	Applied load		Deflection (mm)	rpm Hz	Damping efficiency upon disturbing vibration (%)						
	(N)	(~kg)			500	800	1000	1200	1500	2000	2500
					8.3	13.3	16.7	20.0	25.0	33.3	41.7
2802003000	2000	204	16.7		72.5	90.8	94.3	96.1	97.5	98.6	99.1
	3000	306	25.0		83.2	94.1	96.3	97.4	98.4	99.1	99.4
2802004000	3500	357	21.9		80.4	93.1	95.7	97.1	98.1	99.0	99.3
	4000	408	25.0		83.2	94.1	96.3	97.4	98.4	99.1	99.4
2802006000	5000	510	20.8		79.2	92.8	95.5	96.9	98.0	98.9	99.3
	6000	612	25.0		83.2	94.1	96.3	97.4	98.4	99.1	99.4
2802008000	7000	714	21.9		80.4	93.1	95.7	97.1	98.1	99.0	99.3
	7500	765	23.4		81.9	93.6	96.0	97.3	98.3	99.0	99.4
	8000	815	25.0		83.2	94.1	96.3	97.4	98.4	99.1	99.4
2802010000	9000	917	22.5		81.0	93.4	95.8	97.2	98.2	99.0	99.4
	10000	1019	25.0		83.2	94.1	96.3	97.4	98.4	99.1	99.4
2802012000	11000	1121	22.9		81.4	93.5	95.9	97.2	98.2	99.0	99.4
	11500	1172	24.0		82.4	93.8	96.1	97.3	98.3	99.1	99.4
	12000	1223	25.0		83.2	94.1	96.3	97.4	98.4	99.1	99.4

- 1 Select vibroisolator load capacity in the table - greater or equal to F_s
- 2 Horizontally to the left you can see the product number of Walraven VibraTek®
- 3 Horizontally to the right, you can read the deflection
- 4 Locate the column with a frequency lower than 2300 rpm
- 5 Read the damping performance at: cross deflection and frequency

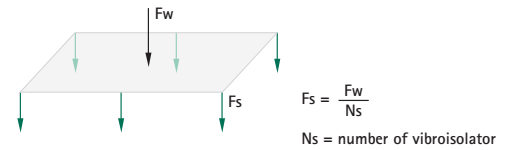

V (%)	Description of damping efficiency
99	Excellent
93	Perfect
88	Very good
81	Good
67	Sufficient
20	Medium
0	No change
Resonance	Better without insulation

Hospitals, hotels, facilities cultural (theaters, centers congress, auditorium)

Residential and office buildings, adjoining rooms to living spaces

Normal requirements: cellars, facilities industrial, shopping centers

Low attenuation or negative impact - contact with the Technical Sales Support Department, to get an alternative solution

Find out how we can support you

Would you like to find out more about any of the solutions described in this Technical Data Sheet?
Or would you like to discuss how we could help you find the best possible solution for your project?
Get in touch today!

Walraven International

Industrieweg 5
3641 RK Mijdrecht (NL)
Tel. +31 297 23 30 00
Fax +31 297 23 30 99
export@walraven.com

Walraven Group

Mijdrecht (NL) · Tienen (BE) · Bayreuth (DE) · Banbury (GB) · Malmö (SE) · Grenoble (FR) · Barcelona (ES) · Milan (IT)
Kraków (PL) · Mladá Boleslav (CZ) · Kyiv (UA) · Danville (US) · Shanghai (CN) · Dubai (AE) · Budapest (HU) · Mumbai (IN)
Singapore (SG) · Burlington (CA) · Athens (GR)

Technical Data Sheet Walraven VibraTek® MS-2X Spring Mount (INT) - 03/2024 - PDF - Full content subject to modifications
* The technical data are non-binding and do not reflect the warranted characteristics of the products. They are subject to change. Please consult our General Terms and Conditions. Additional information is available upon request. It is the designer's responsibility to select products suitable for the intended purpose and to ensure that performance data are not exceeded. The installation instructions should always be read and followed.