

WUP Uni Plug

Standard universal anchor for all types of substrates

Anchor Types



WUP 6x30
WUP 8x40
WUP 10x50
WUP 12x60

Features and Benefits

- High load capacity
- Can be used with wood screws, chipboard screws and metric bolts
- Suitable for variety of substrates
- Easily slides into holes
- Does not slip past collar in deep holes
- Does not expand prematurely
- Resists rotation within holes
- Material: high quality PA6 polyamide

Suitable base materials

- Concrete
- Masonry
- Lightweight concrete
- Sand-lime bricks
- Natural stone
- Gypsum
- Hollow masonry
- Rock

Typical Applications

- Shelves
- Wall-mounted cabinets
- Sanitary fixings
- HVAC and plumbing fixings

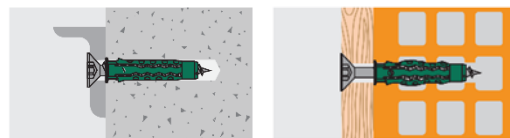

Product Details

Article	Description	Diameter	Length
		d [mm]	L [mm]
6100706	WUP 6x30	6	30
6100708	WUP 8x40	8	40
6100710	WUP 10x50	10	50
6100712	WUP 12x60	12	60

Packaging Details

Article	Description	Pack 1		Pack 2	
		[pcs]	EAN13	[pcs]	EAN13
6100706	WUP 6x30	100	8712993264926	3600	8712993264933
6100708	WUP 8x40	100	8712993264957	3600	8712993264964
6100710	WUP 10x50	50	8712993264988	1800	8712993264995
6100712	WUP 12x60	25	8712993265015	900	8712993265022

Setting Details

Anchor Size			6x30	8x40	10x50	12x60
Length	L	[mm]	30	40	50	60
Drill hole diameter	d_o	[mm]	6	8	10	12
Drill hole depth	h_o	[mm]	40	50	70	80
Nominal anchorage depth	h_{nom}	[mm]	30	40	50	60
Screw diameter wood/ chipboard	d_s	[mm]	3.5-5	4.5-6	6-8	8-10
Screw diameter metric	d_s	[mm]	M4	-	-	-
Min. screwing depth	$l_{s,min}$	[mm]	34	44	54	64
Max. fixture thickness	$t_{fix,max}$	[mm]	based on screw length			

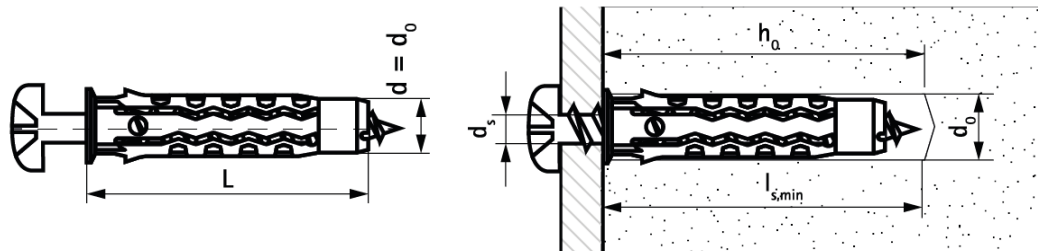

Installation Instructions

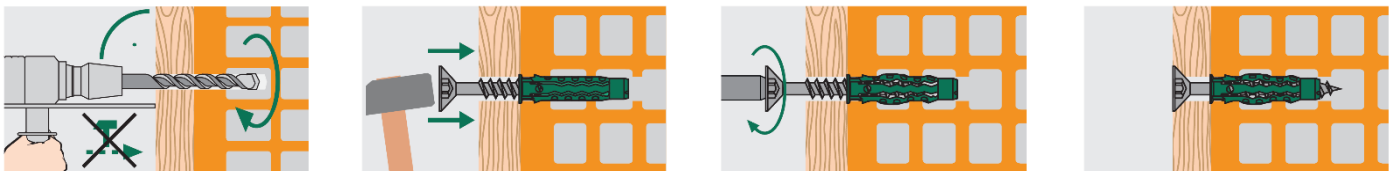

Loading Data

Loading data is presented for single anchors installed with maximum diameter wood screw.

Characteristic loads

Anchor Size			6x30	8x40	10x50	12x60
C20/25 Concrete	N_{rk}	[kN]	2.25	5.75	9.50	13.50
Brick	N_{rk}	[kN]	4.50	5.00	5.50	7.50
Lightweight concrete	N_{rk}	[kN]	0.60	0.95	1.50	2.00
Perforated brick	N_{rk}	[kN]	1.00	2.00	2.25	2.50
Sandstone	N_{rk}	[kN]	3.50	5.00	9.00	10.50

Recommended loads

Anchor Size			6x30	8x40	10x50	12x60
C20/25 Concrete	N_{rec}	[kN]	0.45	1.15	1.90	2.70
Brick	N_{rec}	[kN]	0.90	1.00	1.10	1.50
Lightweight concrete	N_{rec}	[kN]	0.12	0.19	0.30	0.40
Perforated brick	N_{rec}	[kN]	0.20	0.40	0.45	0.50
Sandstone	N_{rec}	[kN]	0.70	1.00	1.80	2.10

Given recommended tension loads include a safety factor of 5.