

# WPF Plasterboard Fixing

A classic hammer-in fixing for plasterboard

## Anchor Types



WPF 12x30  
WPF 12x30/ screw 4x30  
WPF 12x30/ screw 4x50

## Features and Benefits

- Quick and easy to install
- Does not require drilling
- Central thread guide ensures optimum screw positioning
- Sharp tip allows precise installation
- For use with Ø 3.5-5.0mm wood or chipboard screws
- Material: steel, zinc plated

## Suitable base materials

- Plasterboard (9.5-12.5mm)

## Typical Applications

- Light pipes and rails
- Lamps
- Pictures
- Light shelves
- Electrical and sanitary components



## Product Details

Article	Description	Collar diameter	Length	Screw
		d <sub>k</sub> [mm]	L [mm]	[mm]
6110092	WPF 12x30	12	30	-
6110063	WPF 12x30	12	30	-
6110234	WPF 12x30/ screw 4.0x30	12	30	4.0x30
6110263	WPF 12x30/ screw 4.0x30	12	30	4.0x30
6110334	WPF 12x30/ screw 4.0x50	12	30	4.0x50

## Product Details

Article	Description	Pack 1			Pack 2		
		[type]	[pcs]	EAN13	[type]	[pcs]	EAN13
6110092	WPF 12x30	bulk	3000	8719942009584			-
6110063	WPF 12x30	box	200	8719942007597	box	4800	8719942009515
6110234	WPF 12x30/ screw 4.0x30	bag	25	8719942007535	box	5000	8719942009553
6110263	WPF 12x30/ screw 4.0x30	box	200	8719942007559	box	4800	8719942009508
6110334	WPF 12x30/ screw 4.0x50	bag	25	8719942007573	Box	5000	8719942009560

## Setting Details

Anchor Size			12x30	12x30/ screw 4.0x30	12x30/ screw 4.0x50
Length	L	[mm]	30	30	30
Collar diameter	$d_k$	[mm]	12	12	12
Screw length	$l_s$	[mm]	-	30	50
Screw diameter	$d_s$	[mm]	3.5 - 5.0	4.0	4.0
Min. screwing penetration	$l_{s,min}$	[mm]	27	27	27
Max. fixture thickness	$t_{fix,max}$	[mm]	based on screw length	3	23

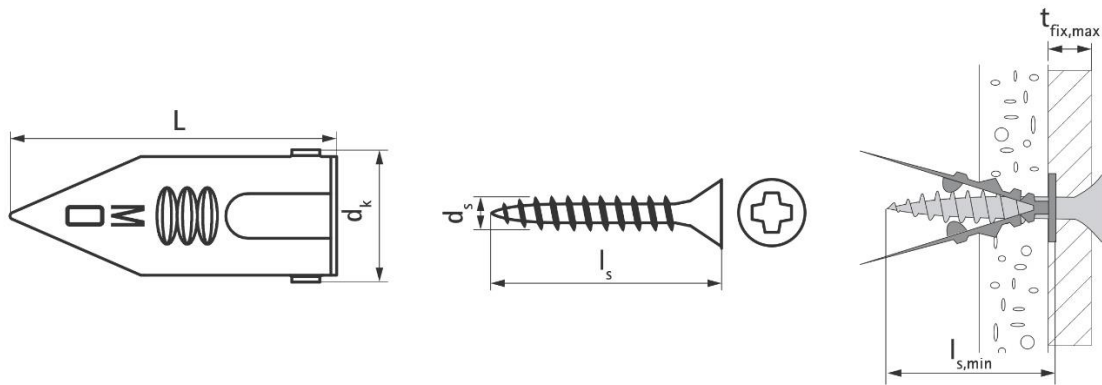

## Installation Instructions

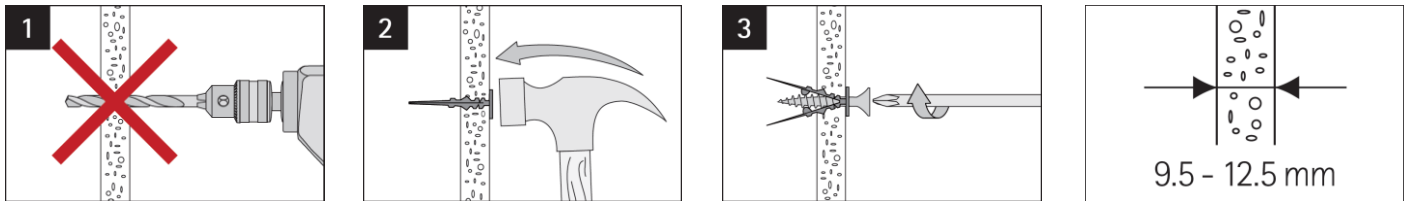

## Loading Data

Loading data is presented for single anchors installed in 12.5mm plasterboard with 4.0mm diameter wood screws and screw penetration of 27mm.

## Characteristic loads

Anchor Size			12x30/ screw 4.0x30
Plasterboard, 12.5mm, Tension	$N_{Rk}$	[N]	204
Plasterboard, 12.5mm, Shear	$V_{Rk}$	[N]	549

## Design loads

Anchor Size			12x30/ screw 4.0x30
Safety Factor for Tension / Shear	$\gamma$		2.0 / 1.5
Plasterboard, 12.5mm, Tension	$N_{Rd}$	[N]	102
Plasterboard, 12.5mm, Shear	$V_{Rd}$	[N]	366