

BIS Hangar vijak

za montažu na zid ili strop

(K 40 05)

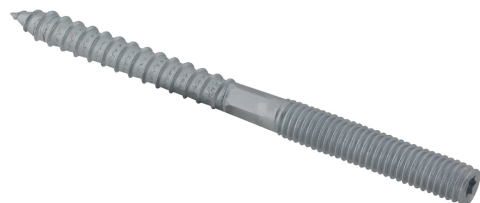

Prednosti i osobine

- sa torx glavom i šesterokutom za fino podešavanje
- elektrizom cinkovan
- materijal: čelik

| Art.br. | G | L | Lh (mm) | Lm1 (mm) | PØ (mm) | SW1 (mm) | Tx | KK | VP |
|-----------|-----|--------|------------|-------------|------------|-------------|----|-----|-------|
| 626 3 606 | M6 | 60 mm | 35 | 25 | 8 | - | - | 100 | 1.000 |
| 626 3 609 | M6 | 90 mm | 30 | 30 | 8 | 5 | - | 100 | 1.000 |
| 626 3 612 | M6 | 120 mm | 30 | 30 | 8 | 5 | - | 100 | 1.000 |
| 626 3 615 | M6 | 150 mm | 30 | 45 | 8 | 5 | - | 100 | 1.000 |
| 626 3 805 | M8 | 50 mm | 35 | 15 | 10 | 6 | 25 | 100 | 1.000 |
| 626 3 806 | M8 | 60 mm | 30 | 20 | 10 | 6 | 25 | 100 | 1.000 |
| 626 3 808 | M8 | 80 mm | 35 | 35 | 10 | 6 | 25 | 100 | 1.000 |
| 626 3 812 | M8 | 120 mm | 50 | 40 | 10 | 6 | 25 | 100 | 500 |
| 626 3 815 | M8 | 150 mm | 50 | 50 | 10 | 6 | 25 | 50 | 500 |
| 626 3 816 | M8 | 160 mm | 60 | 40 | 10 | 6 | 25 | 50 | 250 |
| 626 3 818 | M8 | 180 mm | 60 | 40 | 10 | 6 | 25 | 50 | 250 |
| 628 3 006 | M10 | 60 mm | 35 | 15 | 12 | 8 | 25 | 50 | 500 |
| 628 3 008 | M10 | 80 mm | 35 | 35 | 12 | 8 | 25 | 50 | 500 |
| 628 3 011 | M10 | 110 mm | 50 | 40 | 12 | 8 | 25 | 50 | 500 |
| 628 3 012 | M10 | 120 mm | 50 | 40 | 12 | 8 | 25 | 50 | 500 |
| 628 3 014 | M10 | 140 mm | 50 | 40 | 12 | 8 | 25 | 50 | 500 |
| 628 3 018 | M10 | 180 mm | 55 | 60 | 12 | 8 | 25 | 50 | 250 |
| 628 3 210 | M12 | 100 mm | 45 | 25 | 12 | 10 | - | 50 | - |
| 628 3 212 | M12 | 120 mm | 60 | 35 | 12 | 10 | - | 50 | 250 |
| 628 3 214 | M12 | 140 mm | 60 | 35 | 12 | 10 | - | 50 | - |

