

BIS Sprinkler Clamp HD500 (BUP1000)

(B 12 05)

for sprinkler pipes 25 - 219 mm

M8 - M10 - M12 - M16



Features and benefits

- two-part clamp with two locking bolts
- up to and including 5": locking nut is captive, hidden in plastic holder
- heavy design
- bolts secured with anti-loss washer
- with CO₂ welded connection nut
- material: steel
- surface protection:
 - product is part of the Walraven BIS UltraProtect® 1000 system
 - suitable for in- and outdoor applications
 - stands min. 1,000 hours salt spray test (max. 5% red rust) according to ISO 9227
- with VdS approval - certificate number G 4060019



Part No.	D (mm)	D (")	DN	G	B (mm)	H (mm)	h (mm)	b x s (mm)	cs	F _{a,z} (N)	VdS	Pack 1
4503027	25 - 30	3/4	20	M8/10	85.0	57.0	37.5	30 x 2.5	M8	2,700	VdS	25
4503033	31 - 36	1	25	M8/10	90.5	63.0	40.5	30 x 2.5	M8	2,700	VdS	25
4503042	40 - 45	1 1/4	32	M8/10	101.7	71.0	45.0	30 x 2.5	M8	2,700	VdS	25
4503048	47 - 52	1 1/2	40	M8/10	108.8	78.0	48.5	30 x 2.5	M8	2,700	VdS	25
4503060	59 - 65	2	50	M8/10	120.8	89.5	55.0	30 x 2.5	M8	2,700	VdS	25
4503076	72 - 78	2 1/2	65	M10/12	137.0	112.0	71.0	30 x 3.0	M8	5,000	VdS	25
4503089	86 - 92	3	80	M10/12	151.1	126.0	78.0	30 x 3.0	M8	5,000	VdS	25
4503114	108 - 116	4	100	M10/12	174.8	151.0	90.0	30 x 3.0	M8	5,000	VdS	25
4503139	132 - 140	5	125	M12	199.0	164.0	93.0	30 x 3.0	M8	5,000	VdS	25
4503168	159 - 169	6	150	M12	240.5	192.0	105.0	38 x 4.0	M10	5,800	VdS	15
4503219	208 - 219	8	200	M16	290.8	249.0	134.0	38 x 4.0	M10	5,800	VdS	15

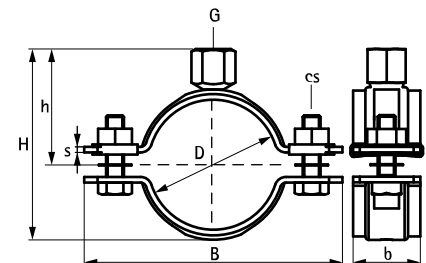

Complementary

BIS Beam Clamp Model C
BIS Roofing Sheet Hanger VdS