

Walraven 'Light Duty' Beam Clamp

fixing to steel beam

(G 40 20)

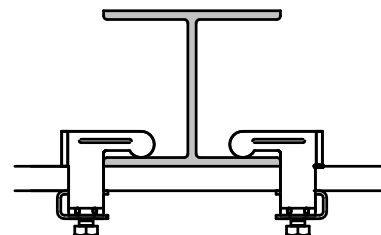

Features and Benefits

- for suspension of light components like cable trays, duct work, etc. onto beams
- material: steel
- zinc plated
- for fixing of rail to a steel beam

| Part No. | A (mm) | For Rail | Pack 1 |
|----------|-----------|----------|--------|
| 6070000 | < 12 | 27x18 | 50 |
| 6071000 | < 20 | 30x15 | 50 |

