

# WHC Hollow Core Anchor

(L 03 81)

for hollow core concrete slabs



## Features and Benefits

- designed specifically for use in precast pre-stressed hollow core concrete slabs
- fire resistance class R30-R120 for design of anchorages under exposure to fire
- very high load capacity

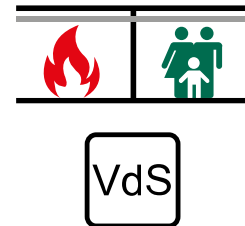

Part No.	Code	Thread (M)	L	d <sub>0</sub> (mm)	h <sub>0</sub> (mm)	T <sub>inst</sub> (Nm)	Pack 1
6096408	WHC	M8	44 mm	12	55	20	50
6096410	WHC	M10	53 mm	16	60	30	50
6096412	WHC	M12	58 mm	18	70	40	25

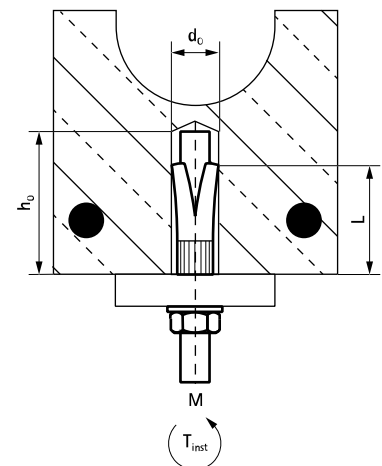

## Complementary

- Walraven Threaded Rod
- BIS Hexagon Nut
- WIS Threaded Rod