

BISOFIX® E19 + Cold Block s1s2

(D 05 141)

for insulated pipes 18 - 168 mm

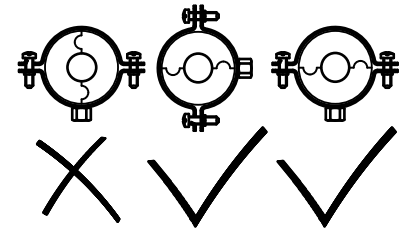

Features and Benefits

- cold block with insulation shell
- for fixing of thermal isolated pipe of steel, copper or stainless steel
- to combine with Bifix® G2 without lining and HD500 Clamps
- effective prevention of corrosion
- reduced smoke development in case of fire by intumescent sheet
- vapour proof glueing to pipe insulation
- when installing the pipe support, always align the contact areas of the insulation shells horizontally (to prevent tensile and pressure forces)
- with intumescent and self-adhesive INCERAM cladding for easy closure of the pipe support
- material: pipe support made of PIR foam (core), synthetic rubber (sides) and a vapour-proof layer of black PVC
- Dichte PIR-Kern Raumgewicht 80 / 120 kg / m³
- does not contain CFC, HCFC, formaldehyde or cadmium
- excellent thermal, mechanical and smoke reducing properties
- Storage and processing temperature ≥ +10 °C
- building material / Euro class according to DIN EN 13501-1 BL-s1, d0 or BL-s2, d0
- application temperature from -50 °C to +110 °C

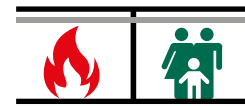

Part No.	D (mm)	L	H (mm)	s (mm)	F _{a,z} (N)	Pack 1
220200171	18	50 mm	56	19	100	20
220200211	22	50 mm	60	19	100	32
220200271	28	50 mm	66	19	100	24
220200351	35	50 mm	73	19	100	38
220200421	42	50 mm	80	19	150	32
220200541	54	50 mm	92	19	225	48
220200601	60	50 mm	98	19	350	44
220200761	76	50 mm	114	19	575	30
220200891	89	50 mm	127	19	875	26
220201141	114	50 mm	152	19	1,250	16
220201401	140	100 mm	178	19	1,700	12
220201681	168	100 mm	206	19	2,125	8

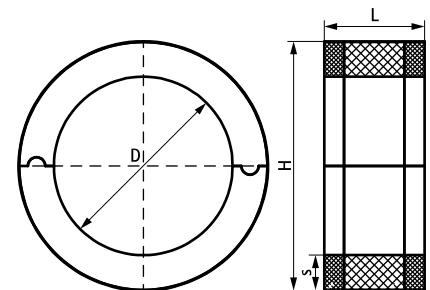

Complementary

- Bifix® G2 (M8/10) (BUP1000)
- BIS Heavy Duty Clamp HD500 (BUP1000)