

# BISOFIX® E13

for insulated pipes 8.0 - 168.3 mm

(D 03 02)

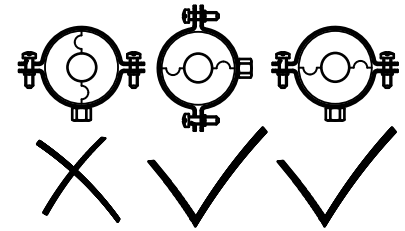

## Features and Benefits

- for combination with elastomeric foam insulation
- temperature range -45 °C - +105 °C
- vapourproof glueable with pipe insulation
- does not contain CFC, HCFC, formaldehyde or cadmium
- fire class B2
- PIR density for D <80mm = 80kg/m<sup>3</sup>
- PIR density for D >80mm = 120kg/m<sup>3</sup>

Part No.	D (mm)	D (")	DN	L	H (mm)	s (mm)	F <sub>az</sub> (N)	Pack 1
I130000008	8.0	-	-	50 mm	34.6	13.3	100	25
I130000010	10.2	-	-	50 mm	36.8	13.3	100	25
I130000012	12.0	-	-	50 mm	38.6	13.3	100	25
I130000015	15.0	-	-	50 mm	41.6	13.3	100	25
I130000018	17.2 - 18.0	3/8	10	50 mm	44.6	13.3	100	25
I130000022	21.3 - 22.0	1/2	15	50 mm	48.6	13.3	100	25
I130000028	26.9 - 28.0	3/4	20	50 mm	55.0	13.5	100	25
I130000035	33.7 - 35.0	1	25	50 mm	61.6	13.3	100	25
I130000042	42.4	1 1/4	32	50 mm	69.0	13.3	150	25
I130000048	48.3	1 1/2	40	50 mm	74.9	13.3	225	25
I130000054	54.0	-	-	50 mm	80.6	13.3	225	25
I130000057	57.0	-	-	50 mm	83.6	13.3	350	25
I130000060	60.3	2	50	50 mm	88.1	13.9	350	25
I130000064	64.0	-	-	50 mm	100.0	18.0	350	25
I130000070	70.0	-	-	50 mm	102.6	16.3	425	25
I130000076	76.1	2 1/2	65	50 mm	108.7	16.3	575	25
I130000089	88.9	3	80	50 mm	124.7	17.9	875	25
I130000102	101.6	-	-	50 mm	134.2	16.3	1,000	25
I130000108	108.0	-	-	50 mm	140.6	16.3	1,075	25
I130000114	114.3	4	100	50 mm	152.1	18.9	1,250	25
I130000133	133.0	-	-	100 mm	165.6	16.3	1,475	25
I130000140	139.7	5	125	100 mm	176.1	18.2	1,700	5
I130000160	159.0 - 160.0	-	-	100 mm	192.6	16.3	1,950	5
I130000168	168.3	6	150	100 mm	200.9	16.3	2,125	5

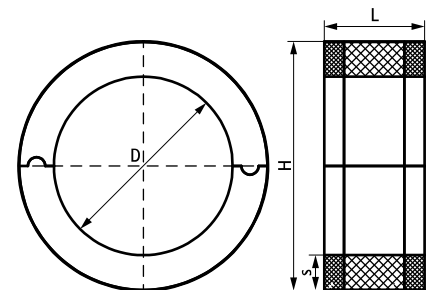

### Complementary

2S Clamp (M8/10)  
Walraven Heavy Duty Clamp HD500  
Walraven Heavy Duty Clamp HD500 (BUP1000)

### Complementary

Bifix® G2 (M8/10) (BUP1000)