

# BISOFIX<sup>®</sup> E13 + Cold Block s1s2

(D 05 140)

for insulated pipes 18 - 54 mm

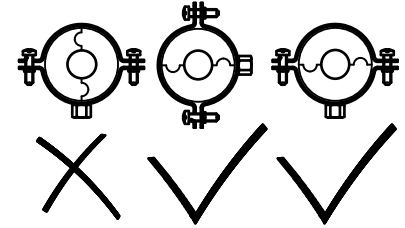

## Features and Benefits

- cold block with insulation shell
- for fixing of thermal isolated pipe of steel, copper or stainless steel
- to combine with Bifix<sup>®</sup> G2 without lining and HD500 Clamps
- effective prevention of corrosion
- reduced smoke development in case of fire by intumescent sheet
- vapour proof glueing to pipe insulation
- when installing the pipe support, always align the contact areas of the insulation shells horizontally (to prevent tensile and pressure forces)
- with intumescent and self-adhesive INCERAM cladding for easy closure of the pipe support
- material: pipe support made of PIR foam (core), synthetic rubber (sides) and a vapour-proof layer of black PVC
- Dichte PIR-Kern Raumgewicht 80 / 120 kg / m<sup>3</sup>
- does not contain CFC, HCFC, formaldehyde or cadmium
- excellent thermal, mechanical and smoke reducing properties
- Storage and processing temperature  $\geq +10$  °C
- building material / Euro class according to DIN EN 13501-1 BL-s1, d0 or BL-s2, d0
- application temperature from -50 °C to +110 °C



Part No.	D (mm)	L	H (mm)	s (mm)	F <sub>a,z</sub> (N)	Pack 1
220100171	18	50 mm	44	13	100	32
220100211	22	50 mm	48	13	100	32
220100271	28	50 mm	54	13	100	40
220100351	35	50 mm	61	13	100	30
220100421	42	50 mm	68	13	150	46
220100541	54	50 mm	80	13	225	32

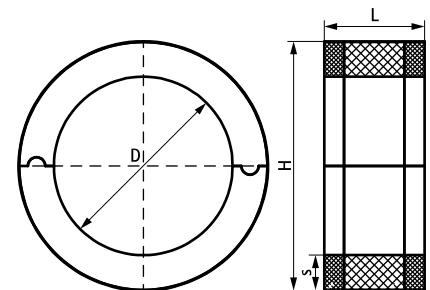

## Complementary

- Bifix<sup>®</sup> G2 (M8/10) (BUP1000)
- BIS Heavy Duty Clamp HD500 (BUP1000)