

BIS Strut Beam Clamp

to make Strut rail fabrications

(H 36 20)

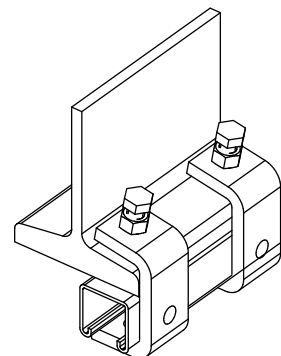

Features and benefits

- for a solid fixing to steel construction without the need for welding or drilling
- always use 2 beam clamps per fixing
- material: steel 1.0332
- zinc plated

| Part No. | For Rail | F _{a,z} (N) | ST | Pack 1 |
|----------|----------------------|-------------------------|-------------|--------|
| 66583736 | Strut 41x41 + 41x21D | 4,500 | zinc plated | 25 |

