

# BIS Bifix® G2 with Lining (M10) (BUP1000)

(A 05 76)

for metal pipes 10 - 225 mm

M10

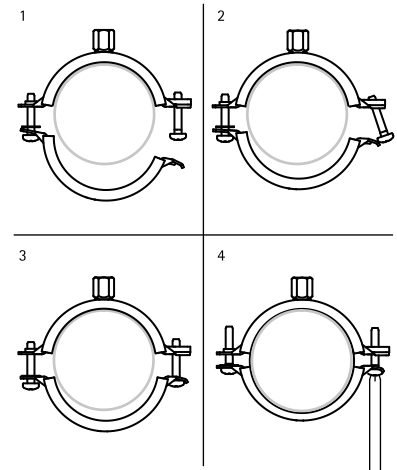

## Features and benefits

- two-screw clamp
- with quick locking system
- material: steel
- surface protection:
  - product is part of the BIS UltraProtect® 1000 system
  - suitable for in- and outdoor applications
  - stands min. 1,000 hours salt spray test (max. 5% red rust) according to ISO 9227
- noise insulating lining, EPDM rubber, black
- sound insulating lining according DIN 4109

| Part No. | D<br>(mm) | D<br>(°) | DN  | G   | B<br>(mm) | h<br>(mm) | b x s<br>(mm) | F <sub>a,z</sub><br>(N) | Pack 1 |
|----------|-----------|----------|-----|-----|-----------|-----------|---------------|-------------------------|--------|
| 3128014  | 10 - 14   | 1/4      | 8   | M10 | 59        | 21        | 20 x 1.25     | 800                     | 50     |
| 3128019  | 15 - 19   | 3/8      | 10  | M10 | 63        | 23        | 20 x 1.25     | 800                     | 50     |
| 3128023  | 20 - 23   | 1/2      | 15  | M10 | 68        | 25        | 20 x 1.25     | 800                     | 50     |
| 3128028  | 25 - 28   | 3/4      | 20  | M10 | 74        | 28        | 20 x 1.25     | 800                     | 50     |
| 3128035  | 31 - 35   | 1        | 25  | M10 | 80        | 31        | 20 x 1.25     | 800                     | 50     |
| 3128039  | 36 - 39   | -        | -   | M10 | 84        | 33        | 20 x 1.25     | 800                     | 50     |
| 3128045  | 40 - 45   | 1 1/4    | 32  | M10 | 91        | 37        | 20 x 1.25     | 800                     | 50     |
| 3128052  | 48 - 52   | 1 1/2    | 40  | M10 | 97        | 40        | 20 x 1.25     | 800                     | 50     |
| 3128058  | 54 - 58   | -        | -   | M10 | 104       | 43        | 20 x 1.25     | 800                     | 50     |
| 3128064  | 60 - 64   | 2        | 50  | M10 | 109       | 46        | 20 x 1.25     | 800                     | 50     |
| 3128070  | 66 - 70   | -        | -   | M10 | 118       | 52        | 20 x 1.50     | 1,000                   | 50     |
| 3128079  | 75 - 79   | 2 1/2    | 65  | M10 | 125       | 56        | 20 x 1.50     | 1,000                   | 50     |
| 3128083  | 80 - 83   | -        | -   | M10 | 131       | 59        | 20 x 1.50     | 1,000                   | 50     |
| 3128091  | 88 - 91   | 3        | 80  | M10 | 142       | 64        | 23 x 2.00     | 1,800                   | 25     |
| 3128105  | 100 - 105 | -        | -   | M10 | 155       | 71        | 23 x 2.00     | 1,800                   | 25     |
| 3128115  | 108 - 115 | 4        | 100 | M10 | 163       | 75        | 23 x 2.00     | 1,800                   | 25     |
| 3128130  | 125 - 130 | -        | -   | M10 | 180       | 83        | 23 x 2.00     | 1,800                   | 25     |
| 3128140  | 133 - 140 | 5        | 125 | M10 | 189       | 88        | 23 x 2.00     | 1,800                   | 25     |
| 3128160  | 152 - 160 | -        | -   | M10 | 208       | 97        | 23 x 2.00     | 1,800                   | 25     |
| 3128169  | 165 - 169 | 6        | 150 | M10 | 225       | 103       | 25 x 2.50     | 2,500                   | 10     |
| 3128180  | 176 - 180 | -        | -   | M10 | 238       | 109       | 25 x 2.50     | 2,500                   | 15     |
| 3128200  | 192 - 200 | -        | -   | M10 | 257       | 119       | 25 x 2.50     | 2,500                   | 15     |
| 3128210  | 205 - 210 | -        | -   | M10 | 269       | 125       | 25 x 2.50     | 2,500                   | 10     |
| 3128225  | 219 - 225 | 8        | 200 | M10 | 283       | 132       | 25 x 2.50     | 2,500                   | 10     |

