

BIS Bifix[®] G2 with Lining (M10) (BUP1000)

(A 05 76)

for metal pipes 10 - 225 mm

M10

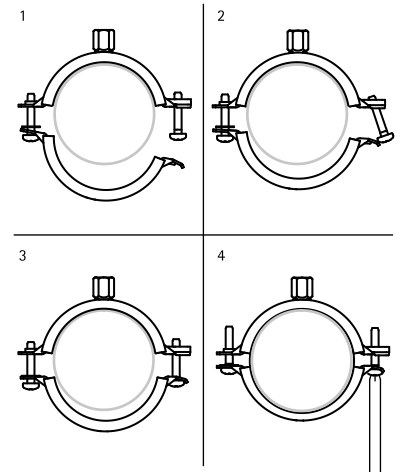

Features and benefits

- two-screw clamp
- with quick locking system
- material: steel
- surface protection:
 - product is part of the BIS UltraProtect[®] 1000 system
 - suitable for in- and outdoor applications
 - stands min. 1,000 hours salt spray test (max. 5% red rust) according to ISO 9227
- noise insulating lining, EPDM rubber, black
- sound insulating lining according DIN 4109

| Part No. | D (mm) | D (°) | DN | G | B (mm) | h (mm) | b x s (mm) | F _{a,z} (N) | Pack 1 |
|----------|-----------|----------|-----|-----|-----------|-----------|---------------|-------------------------|--------|
| 3128014 | 10 - 14 | 1/4 | 8 | M10 | 59 | 21 | 20 x 1.25 | 800 | 50 |
| 3128019 | 15 - 19 | 3/8 | 10 | M10 | 63 | 23 | 20 x 1.25 | 800 | 50 |
| 3128023 | 20 - 23 | 1/2 | 15 | M10 | 68 | 25 | 20 x 1.25 | 800 | 50 |
| 3128028 | 25 - 28 | 3/4 | 20 | M10 | 74 | 28 | 20 x 1.25 | 800 | 50 |
| 3128035 | 31 - 35 | 1 | 25 | M10 | 80 | 31 | 20 x 1.25 | 800 | 50 |
| 3128039 | 36 - 39 | - | - | M10 | 84 | 33 | 20 x 1.25 | 800 | 50 |
| 3128045 | 40 - 45 | 1 1/4 | 32 | M10 | 91 | 37 | 20 x 1.25 | 800 | 50 |
| 3128052 | 48 - 52 | 1 1/2 | 40 | M10 | 97 | 40 | 20 x 1.25 | 800 | 50 |
| 3128058 | 54 - 58 | - | - | M10 | 104 | 43 | 20 x 1.25 | 800 | 50 |
| 3128064 | 60 - 64 | 2 | 50 | M10 | 109 | 46 | 20 x 1.25 | 800 | 50 |
| 3128070 | 66 - 70 | - | - | M10 | 118 | 52 | 20 x 1.50 | 1,000 | 50 |
| 3128079 | 75 - 79 | 2 1/2 | 65 | M10 | 125 | 56 | 20 x 1.50 | 1,000 | 50 |
| 3128083 | 80 - 83 | - | - | M10 | 131 | 59 | 20 x 1.50 | 1,000 | 50 |
| 3128091 | 88 - 91 | 3 | 80 | M10 | 142 | 64 | 23 x 2.00 | 1,800 | 25 |
| 3128105 | 100 - 105 | - | - | M10 | 155 | 71 | 23 x 2.00 | 1,800 | 25 |
| 3128115 | 108 - 115 | 4 | 100 | M10 | 163 | 75 | 23 x 2.00 | 1,800 | 25 |
| 3128130 | 125 - 130 | - | - | M10 | 180 | 83 | 23 x 2.00 | 1,800 | 25 |
| 3128140 | 133 - 140 | 5 | 125 | M10 | 189 | 88 | 23 x 2.00 | 1,800 | 25 |
| 3128160 | 152 - 160 | - | - | M10 | 208 | 97 | 23 x 2.00 | 1,800 | 25 |
| 3128169 | 165 - 169 | 6 | 150 | M10 | 225 | 103 | 25 x 2.50 | 2,500 | 10 |
| 3128180 | 176 - 180 | - | - | M10 | 238 | 109 | 25 x 2.50 | 2,500 | 15 |
| 3128200 | 192 - 200 | - | - | M10 | 257 | 119 | 25 x 2.50 | 2,500 | 15 |
| 3128210 | 205 - 210 | - | - | M10 | 269 | 125 | 25 x 2.50 | 2,500 | 10 |
| 3128225 | 219 - 225 | 8 | 200 | M10 | 283 | 132 | 25 x 2.50 | 2,500 | 10 |

