

Walraven Strut Beam Clamp

(H 36 20)

to make Strut rail fabrications

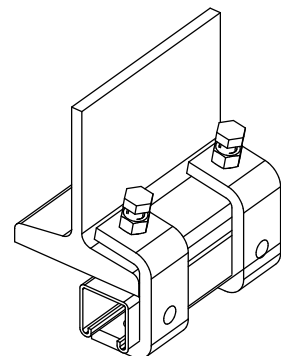

Features and Benefits

- for a solid fixing to steel construction without the need for welding or drilling
- always use 2 beam clamps per fixing
- material: steel 1.0332
- zinc plated

Part No.	For Rail	F _{a,z} (N)	ST	Pack 1
66583736	Strut 41x41 + 41x21D	4,500	zinc plated	25

