

Walraven RapidStrut® Ball Swivel Hanger

(H 24 75)

fixing to Strut rail



Features and Benefits

- slide nut with ball swivel hanger, washer and BIS RapidStrut® spring
- recommended for metal pipes up to DN 50, plastic pipes up to DN 100
- ready-to-use pre-assembled for a quick fixing, and retains assembly in place before final tightening
- with inspection hole to check screw-in depth (attention: when the threaded rod is screwed-in too deep, the ball swivel is blocked)
- screw-in depth is continuously variable (see LU)
- tested for fire safety according to EN 1363-1
- material: metal parts made of steel 1.0332; spring(s) made of POM (polyoxymethylene), green
- zinc plated

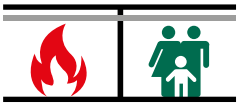
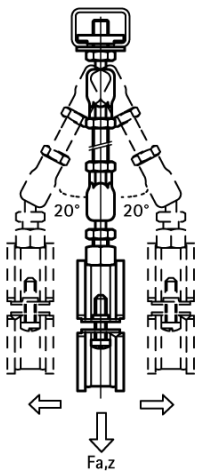

Part No.	G	L	LU	s	Lm1	SW1	SW2	T _(inst.)	For Rail	F _{a,z}	Pack 1
66530805	M8	80 mm	43	6.0	50	13	10	15.0	Strut	3,100	25
66530005	M10	80 mm	43	8.0	50	13	12	15.0	Strut	3,100	25

Please note. Always use 2 ball swivel hangers and secure by additional hexagon nut (see application picture). The maximum length change that can be dealt with, depends on the fixing distance (ceiling - pipe). The height difference that occurs as a result, needs to be taken into consideration. To be used in combination with BIS Ball Swivel Hangers. Product can be found on page E 10 05.

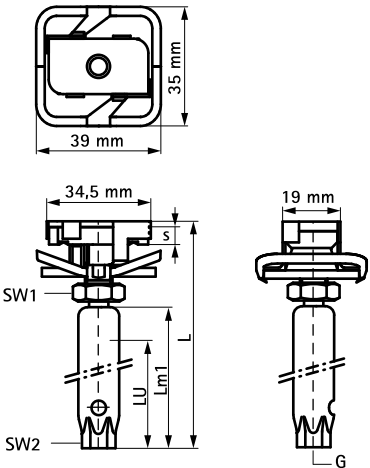

Complementary

- BIS Ball Swivel Hanger
- Walraven RapidStrut® Cantilever Arm (BUP1000)
- Walraven RapidStrut® Fixing Rail DS 5 (BUP1000)