

# Walraven RapidRail® Cantilever Arm

(G 10 07)

fixing to wall, floor or ceiling



## Features and Benefits

- base plate with welded C-profile
- for quick and adjustable fixing of one or multiple pipes
- CO<sub>2</sub> welded
- with continuous perforation
- with sawing marks each 50 mm
- unique hole pattern at type 30x20 and 38x40 allows to click in Walraven RapidRail® Hammerfix from both sides
- material: base plate made of steel 1.0332 (DD11)
- material: profiles type 27x18 and 30x20 made of steel 1.0330 (DC01)
- material: profiles type 30x15, 30x30 and 38x40 made of steel 1.0038 (S235JR)
- zinc plated
- type 38x40 is part of the Walraven BIS UltraProtect® 1000 system
- for more information about the max. allowed load ( $F_{a,z}$ ) please refer to the loading tables or our online datasheet 'Technical Details Walraven RapidRail®'

| Part No. | Type  | L        | B    | H    | s    | d1      | S    | k    | Pack 1 |
|----------|-------|----------|------|------|------|---------|------|------|--------|
|          |       |          | (mm) | (mm) | (mm) | (mm)    | (mm) | (mm) |        |
| 66031815 | 27x18 | 150 mm   | 38   | 110  | 4.0  | 16 x 11 | 15   | 70   | 20     |
| 66031820 | 27x18 | 200 mm   | 38   | 110  | 4.0  | 16 x 11 | 15   | 70   | 20     |
| 66031830 | 27x18 | 300 mm   | 38   | 110  | 4.0  | 16 x 11 | 15   | 70   | 20     |
| 66031850 | 27x18 | 500 mm   | 38   | 110  | 4.0  | 16 x 11 | 15   | 70   | 20     |
| 66031520 | 30x15 | 200 mm   | 38   | 110  | 4.0  | 16 x 11 | 15   | 70   | 20     |
| 66031530 | 30x15 | 300 mm   | 38   | 110  | 4.0  | 16 x 11 | 15   | 70   | 20     |
| 66032015 | 30x20 | 150 mm   | 38   | 110  | 4.0  | 16 x 11 | 15   | 70   | 20     |
| 66032020 | 30x20 | 200 mm   | 38   | 110  | 4.0  | 16 x 11 | 15   | 70   | 20     |
| 66032025 | 30x20 | 250 mm   | 38   | 110  | 4.0  | 16 x 11 | 15   | 70   | 20     |
| 66033020 | 30x30 | 200 mm   | 48   | 110  | 5.0  | 18 x 11 | 15   | 70   | 10     |
| 66033025 | 30x30 | 250 mm   | 48   | 110  | 5.0  | 18 x 11 | 15   | 70   | 10     |
| 66033030 | 30x30 | 300 mm   | 48   | 110  | 5.0  | 18 x 11 | 15   | 70   | 10     |
| 66033040 | 30x30 | 400 mm   | 48   | 110  | 5.0  | 18 x 11 | 15   | 70   | 20     |
| 66033050 | 30x30 | 500 mm   | 48   | 110  | 5.0  | 18 x 11 | 15   | 70   | 20     |
| 66036820 | 38x40 | 200 mm   | 48   | 130  | 5.0  | 25 x 11 | 15   | 90   | 10     |
| 66036825 | 38x40 | 250 mm   | 48   | 130  | 5.0  | 25 x 11 | 15   | 90   | 10     |
| 66036835 | 38x40 | 350 mm   | 48   | 130  | 5.0  | 25 x 11 | 15   | 90   | 10     |
| 66036840 | 38x40 | 400 mm   | 48   | 130  | 5.0  | 25 x 11 | 15   | 90   | 10     |
| 66036850 | 38x40 | 500 mm   | 48   | 130  | 5.0  | 25 x 11 | 15   | 90   | 10     |
| 66036860 | 38x40 | 600 mm   | 48   | 130  | 5.0  | 25 x 11 | 15   | 90   | 8      |
| 66036875 | 38x40 | 750 mm   | 48   | 130  | 5.0  | 25 x 11 | 15   | 90   | 8      |
| 66036805 | 38x40 | 1,050 mm | 48   | 130  | 5.0  | 25 x 11 | 15   | 90   | -      |

For more information about the max. allowed load ( $F_{a,z}$ ) please refer to the loading tables or our online datasheet 'Technical Details Walraven RapidRail®'.

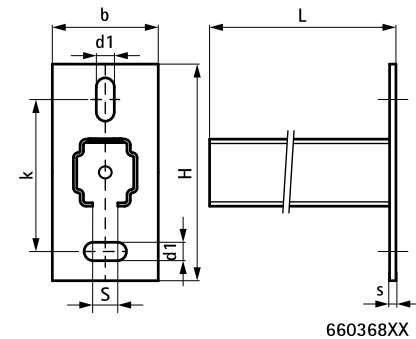
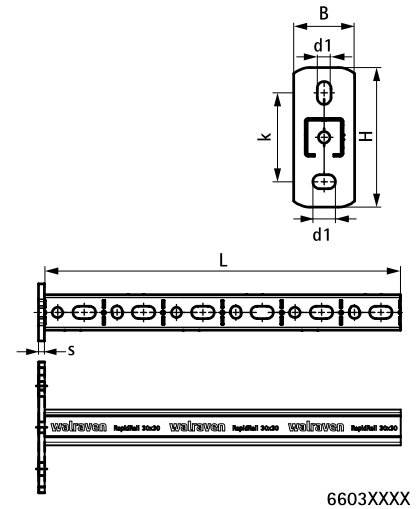

### Complementary

Walraven Rail Prop  
Walraven RapidRail® Slide Nut  
Walraven Rail End Cap

### Complementary

Walraven RapidRail® Hammerfix  
Walraven Rubber Strip  
BIS Expansion Device