

# Walraven Flexible Rail Prop

(H 1607)

reinforcement of rail fabrications

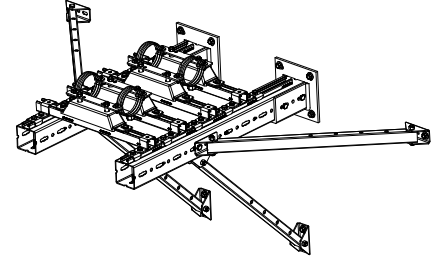

## Features and Benefits

- flexible angle support bracket
- to strengthen rail constructions
- by additional holes the length can be reduced in steps of 100mm
- suitable for Strut rails and for Maxx rails
- material: u-plate steel 1.0242 (S250GD);  
tube profile: steel 1.0038 (S235JR)
- u-plate: ZM310-MAC (pre-galvanized);  
tube profile: hot-dip galvanized 50-80 µm

Part No.	L	B (mm)	H (mm)	d1 (mm)	k (mm)	F <sub>a,z</sub> (N)	Pack 1
6621083	929	83	92	25 x 12.2	70.6	7,500	-

*The (F<sub>a,z</sub>) value is the safe load in axial direction (tension or compression) that the product can withstand in its longest version (uncutted) without damaging the connection holes or buckling the rail.*

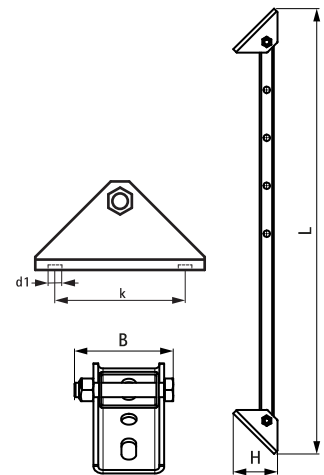

## Complementary

- Walraven RapidStrut® Fixing Rail (pg)
- Walraven RapidStrut® Fixing Rail Double (pg)
- WTB1 Throughbolt Anchor

## Alternative

- Walraven Rail Prop (BUP1000)