

BIS Strut Beam Clamp

to make Strut rail fabrications

(H 36 20)

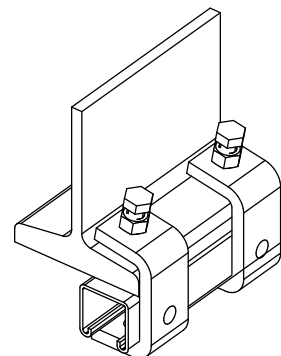

Features and Benefits

- for a solid fixing to steel construction without the need for welding or drilling
- always use 2 beam clamps per fixing
- material: steel 1.0332

Part No.	For Rail	F _{a,z} (N)	ST	Pack 1
66583736	Strut 41x41 + 41x21D	4,500	zinc plated	25
<i>Also available in stainless steel 1.4404 (AISI 316L).</i>				

