

BIS Nail-in Clamp

(B 25 05)

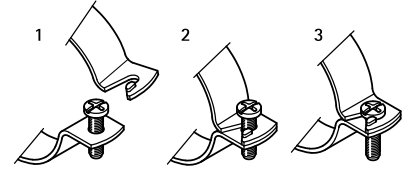

Features and Benefits

- two-screw clamp on hammer-in stud
- clamp with quick locking system
- type ST: for gas-pipe and conduit-pipe
- type KA: for plastic pipe
- material: steel
- zinc plated

Part No.	D (")	DN	Type	B (mm)	H (mm)	s (mm)	PL (mm)	HØ (mm)	Pack 1
3861021	-	15	ST	55	109	1.15	80	5	100
3861027	¾	20	ST	63	116	1.15	80	5	100
3861033	1	25	ST	66	120	1.15	80	5	100
3861043	1¼	32	ST	75	131	1.15	80	6	50
3861061	2	50	ST	97	152	2.00	80	6	50
3862040	-	40	KA	72	129	2.00	80	6	100
3862050	-	50	KA	86	139	2.00	80	6	100
3862070	-	70	KA	116	183	1.50	100	6	50
3862100	-	100	KA	144	217	1.50	100	6	25
3862125	-	125	KA	161	250	2.00	120	7	25
3862150	-	150	KA	196	285	2.00	120	7	25

ST = gas-pipe and conduit-pipe

KA = Plastic drain pipe.

Type ST also available with stud 150 mm (Part No. 387 1 XXX).

Other dimensions up to DN 200 can be supplied quickly.

