

# Walraven Heavy Duty Clamp HD500 (BUP1000)

(B 10 04)

for steel pipes 15 - 227 mm

M8/10 - M10/12



## Features and benefits

- two-part clamp with two locking bolts
- up to and including 5": locking nut is captive, hidden in plastic holder
- heavy design
- bolts secured with anti-loss washer
- with CO<sub>2</sub> welded connection nut
- material: steel
- surface protection:
  - product is part of the Walraven BIS UltraProtect® 1000 system
  - suitable for in- and outdoor applications
  - stands min. 1,000 hours salt spray test (max. 5% red rust) according to ISO 9227
- tested for fire safety



Part No.	D (mm)	D (")	DN	G	B (mm)	H (mm)	h (mm)	b x s (mm)	cs	F <sub>a,z</sub> (N)	RAL	Pack 1
33038019	15 - 19	3/8	10	M8/10	75	46	32	30 x 2.5	M8	2,100	RAL <sup>2</sup>	25
33038023	19 - 23	1/2	15	M8/10	78	50	34	30 x 2.5	M8	2,100	RAL <sup>2</sup>	25
33038030	25 - 30	3/4	20	M8/10	85.1	49	29.5	30 x 2.5	M8	2,100	RAL <sup>2</sup>	25
33038036	31 - 36	1	25	M8/10	90.5	55	32.5	30 x 2.5	M8	2,100	RAL <sup>2</sup>	25
33038042	37 - 42	-	-	M8/10	98	69	44	30 x 2.5	M8	2,100	RAL <sup>2</sup>	25
33038045	40 - 45	1 1/4	32	M8/10	101.7	64	37	30 x 2.5	M8	2,100	RAL <sup>2</sup>	25
33038052	47 - 52	1 1/2	40	M8/10	109	79	49	30 x 2.5	M8	2,100	RAL <sup>2</sup>	25
33038058	53 - 58	-	-	M8/10	115	85	52	30 x 2.5	M8	2,100	RAL <sup>2</sup>	25
33038065	59 - 65	2	50	M8/10	120.8	84	47	30 x 2.5	M8	2,100	RAL <sup>2</sup>	25
33038071	66 - 71	-	-	M8/10	129	98	58	30 x 2.5	M8	2,100	RAL <sup>2</sup>	25
33048078	72 - 78	2 1/2	65	M10/12	136	115	70	30 x 3.0	M8	4,000	RAL <sup>2</sup>	25
33048085	79 - 85	-	-	M10/12	144	122	75	30 x 3.0	M8	4,000	RAL <sup>2</sup>	25
33048092	86 - 92	3	80	M10/12	152	129	78	30 x 3.0	M8	4,000	RAL <sup>2</sup>	25
33048106	98 - 106	-	-	M10/12	165	143	85	30 x 3.0	M8	4,000	RAL <sup>2</sup>	25
33048116	108 - 116	4	100	M10/12	175	153	90	30 x 3.0	M8	4,000	RAL <sup>2</sup>	25
33048123	116 - 123	-	-	M10/12	182	160	94	30 x 3.0	M8	4,000	RAL <sup>2</sup>	25
33048133	125 - 133	-	-	M10/12	193	170	99	30 x 3.0	M8	4,000	RAL <sup>2</sup>	25
33048140	132 - 140	5	125	M10/12	200	177	102	30 x 3.0	M8	4,000	RAL <sup>2</sup>	25
33048154	148 - 154	-	-	M10/12	215	191	109	30 x 3.0	M8	4,000	RAL <sup>1</sup>	15
33048169	159 - 169	6	150	M10/12	240	207	117	38 x 4.0	M10	8,200	RAL <sup>1</sup>	15
33048183	173 - 183	-	-	M10/12	254	221	124	38 x 4.0	M10	8,200	RAL <sup>1</sup>	15
33048202	192 - 202	-	-	M10/12	274	240	133	38 x 4.0	M10	8,200	RAL <sup>1</sup>	15
33048219	208 - 219	-	-	M10/12	290	256	141	38 x 4.0	M10	8,200	RAL <sup>1</sup>	15
33048227	217 - 227	8	200	M10/12	299	265	146	38 x 4.0	M10	8,200	RAL <sup>1</sup>	2

RAL<sup>1</sup> = tested, certified and monitored by a third party according to RAL-GZ 655/B.

RAL<sup>2</sup> = tested, certified and monitored by a third party according to RAL-GZ 655/B and RAL-GZ 656.

For detailed technical information about our RAL marked products, please see the RAL datasheet in our web catalogue.

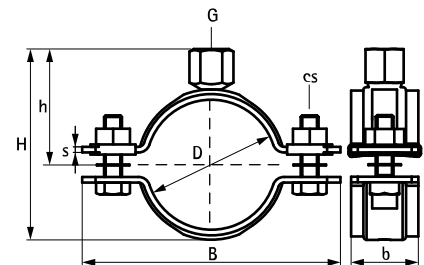

### Complementary

Walraven RapidStrut® Fixing System  
Walraven Fixing Accessories  
Walraven Fastenings

### Complementary

BIS dB-FIX® 80 Fixing Point Assembly

### Alternative

BIS Heavy Duty Clamp HD1501 (BUP1000)