

# Walraven RapidRail® Hammerfix

(G 30 210)

fixing to Walraven RapidRail®

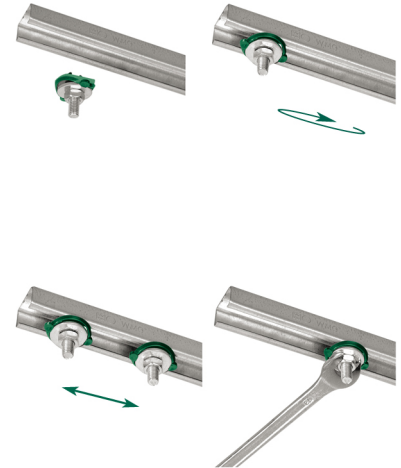

## Features and benefits

- slide nut with female thread, washer and BIS RapidRail® spring
- ready-to-use pre-assembled for a quick fixing, and retains assembly in place before final tightening
- replaces tee-nut, washer and threaded rod with 1 piece assembly
- no need to measure and cut rod!
- material: metal parts made of steel 1.0332; spring(s) made of POM (polyoxymethylene), green
- zinc plated
- conforms to MFMA Metal Framing Standards (Metal Framing Manufacturers Association)
- Plenum rated - tested to ASTM E-84

Part No.	G	L	LU (")	b x s (mm)	SW1 (")	For Rail	Pack 1	Pack 2
RR6523902	3/8"	1 1/2"	1	13.5 x 5	3/8	WM15	25	250
RR6523908	3/8"	3"	2.5	13.5 x 5	3/8	WM15	25	250

