

# Walraven RapidRail® Ball Swivel Hanger

(G 30 60)

fixing to Walraven RapidRail®



## Features and benefits

- slide nut with ball swivel hanger, washer and BIS RapidRail® spring
- recommended for metal pipes up to DN 50, plastic pipes up to DN 100
- suitable for rail 27x18, 30x15, 30x20, 30x30, 30x45, 38x40
- ready-to-use pre-assembled for a quick fixing, and retains assembly in place before final tightening
- with inspection hole to check screw-in depth (attention: when the threaded rod is screwed-in too deep, the ball swivel is blocked)
- screw-in depth is continuously variable (see LU)
- material: metal parts made of steel 1.0332; spring(s) made of POM (polyoxymethylene), green
- zinc plated

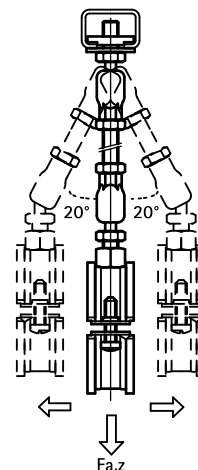

RAL-GZ 655/D  
Cert.Nr. 2012-11

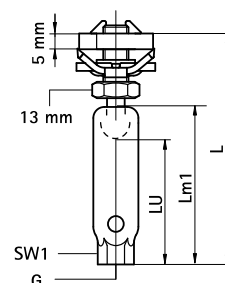
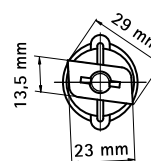

## Complementary

BIS Ball Swivel Hanger  
BIS Stud Bolt  
BIS Threaded Rod

## Complementary

Walraven RapidRail® Fixing Rail  
Walraven RapidRail® Cantilever Arm

# Walraven RapidRail® Ball Swivel Hanger

(G 30 60)

fixing to Walraven RapidRail®



with Rail 30x15, 30x30, 30x20 and 30x45.

For detailed technical information about our RAL marked products, please see the RAL datasheet in our web catalogue.

Please note. Always use 2 ball swivel hangers and secure by additional hexagon nut (see application picture). The maximum length change that can be dealt with, depends on the fixing distance (ceiling - pipe). The height difference that occurs as a result, needs to be taken into consideration.

To be used in combination with BIS Ball Swivel Hangers. Product can be found on page E 10 05.

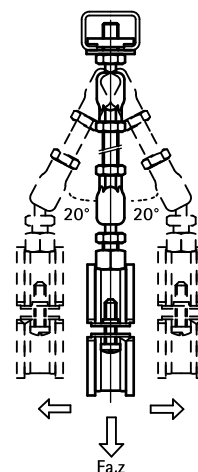

RAL-GZ 655/D  
Cert.Nr. 2012-11

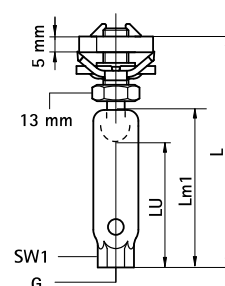
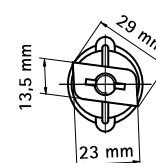

## Complementary

BIS Ball Swivel Hanger  
BIS Stud Bolt  
BIS Threaded Rod

## Complementary

Walraven RapidRail® Fixing Rail  
Walraven RapidRail® Cantilever Arm