

BISOFIX[®] PIR20

for insulated pipes 12,0 - 273,1 mm

(D 03 50)

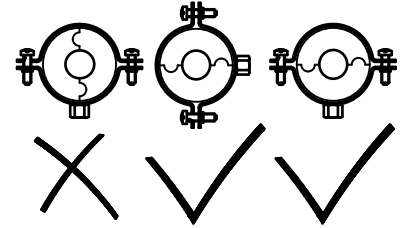

Features and benefits

- for combination with rigid foam insulation
- cover joints with aluminium tape
- does not contain CFC, HCFC, formaldehyde or cadmium
- fire class B2
- PIR density for $D < 110\text{mm} = 80\text{kg/m}^3$
- PIR density for $D > 110\text{mm} = 120\text{kg/m}^3$
- thermal conductivity lambda (approx. value): 0.30 W/(mK)
- temperature range $-45\text{ °C} - +105\text{ °C}$

Part No.	D (mm)	D (")	DN	L	H (mm)	s (mm)	F _{az} (N)	Pack 1
I200000012	12,0	-	-	75 mm	52.0	20.0	120	25
I200000015	15,0 - 16,0	-	-	75 mm	55.0	20.0	160	25
I200000018	17,2 - 18,0	3/8	10	75 mm	58.0	20.0	170	25
I200000022	21,3 - 22,0	1/2	15	75 mm	62.0	20.0	180	25
I200000028	26,9 - 28,0	3/4	20	75 mm	68.0	20.0	200	25
I200000034	33,7 - 35,0	-	-	75 mm	75.0	20.0	220	25
I200000042	42,4	1 1/4	32	75 mm	82.4	20.0	280	25
I200000048	48,3	1 1/2	40	75 mm	88.3	20.0	300	25
I200000054	54,0	-	-	75 mm	94.0	20.0	320	25
I200000057	56,0 - 57,0	-	-	75 mm	97.0	20.0	330	25
I200000060	60,3	2	50	75 mm	100.3	20.0	340	25
I200000064	64,0	-	-	75 mm	104.0	20.0	350	25
I200000070	70,0	-	-	75 mm	110.0	20.0	370	25
I200000076	76,1	2 1/2	65	75 mm	116.1	20.0	390	25
I200000102	101,6	-	-	75 mm	141.6	20.0	450	25
I200000108	108,0	-	-	75 mm	148.0	20.0	500	25
I200000114	114,3	4	100	100 mm	154.3	20.0	1,110	15
I200000133	133,0	-	-	100 mm	173.0	20.0	1,360	5
I200000140	139,7	5	125	100 mm	179.7	20.0	1,410	5
I200000160	159,0 - 160,0	-	-	100 mm	200.0	20.0	1,520	5
I200000168	168,3	6	150	100 mm	208.3	20.0	1,570	5
I200000219	219,1	8	200	150 mm	259.1	20.0	1,620	2
I200000273	273,1	-	-	150 mm	313.0	20.0	1,670	2

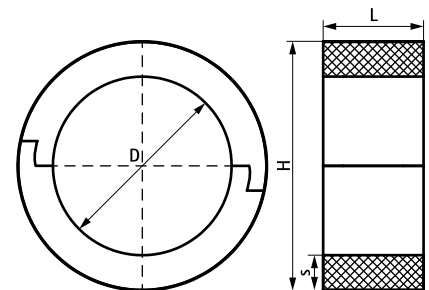

Complementary

Bifix[®] G2 (M8/10) (BUP1000)
 2S Clamp (M8/10)
 BIS Heavy Duty Clamp HD500 (BUP1000)

Complementary

BIS Heavy Duty Clamp HD500 (BUP1000)