

**BISOFIX® E32**

(D 03 38)

for insulated pipes 12,0 - 273,1 mm

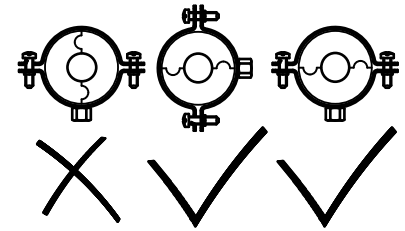

**Features and benefits**

- for combination with elastomeric foam insulation
- vapourproof glueable with pipe insulation
- does not contain CFC, HCFC, formaldehyde or cadmium
- fire class B2
- PIR density for D <80mm = 80kg/m<sup>3</sup>
- PIR density for D >80mm = 120kg/m<sup>3</sup>
- temperature range -45 °C - +105 °C

Part No.	D (mm)	D (°)	DN	L	H (mm)	s (mm)	F <sub>a,z</sub> (N)	Pack 1
I320000012	12,0	-	-	50 mm	76.6	32.3	100	25
I320000015	15,0	-	-	50 mm	80.0	32.5	100	25
I320000018	17,2 - 18,0	3/8	10	50 mm	82.6	32.3	100	25
I320000022	21,3 - 22,0	1/2	15	50 mm	88.0	33.0	100	25
I320000028	27,0 - 28,0	3/4	20	50 mm	100.0	36.0	100	25
I320000035	33,7 - 35,0	1	25	50 mm	100.0	32.5	100	25
I320000042	42,4	1 1/4	32	50 mm	108.0	32.8	150	25
I320000048	48,3	1 1/2	40	50 mm	112.9	32.3	225	25
I320000054	54,0	-	-	50 mm	124.6	35.3	225	25
I320000060	60,3	2	50	50 mm	124.9	32.3	350	25
I320000064	64,0	-	-	50 mm	152.0	44.0	350	15
I320000070	70,0	-	-	50 mm	152.0	41.0	425	15
I320000076	76,1	2 1/2	65	50 mm	156.7	40.3	575	15
I320000089	88,9	3	80	50 mm	176.1	43.6	875	5
I320000102	101,6	-	-	50 mm	192.0	45.2	1,000	5
I320000108	108,0	-	-	50 mm	192.0	42.0	1,075	5
I320000114	114,3	4	100	50 mm	194.9	40.3	1,250	5
I320000133	133,0	-	-	100 mm	218.4	42.7	1,475	5
I320000140	139,7	5	125	100 mm	220.3	40.3	1,700	5
I320000160	159,0 - 160,0	-	-	100 mm	241.0	40.5	1,950	3
I320000168	168,3	6	150	100 mm	248.9	40.3	2,125	3
I320000219	219,1	8	200	100 mm	315.1	48.0	3,525	3
I320000273	273,1	10	250	100 mm	353.6	40.3	4,925	3

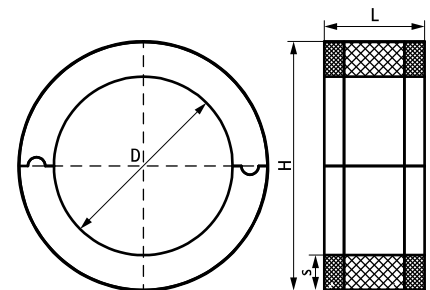

**Complementary**

- Bifix® G2 (M8/10) (BUP1000)
- 2S Clamp (M8/10)
- BIS Heavy Duty Clamp HD500 (BUP1000)

**Complementary**

- BIS Heavy Duty Clamp HD500 (BUP1000)