

BISOFIX® E25

(D 03 26)

for insulated pipes 12,0 - 219,1 mm

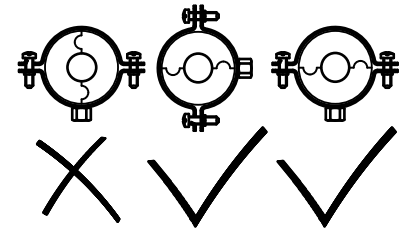

Features and benefits

- for combination with elastomeric foam insulation
- vapourproof glueable with pipe insulation
- does not contain CFC, HCFC, formaldehyde or cadmium
- fire class B2
- PIR density for D <80mm = 80kg/m³
- PIR density for D >80mm = 120kg/m³
- temperature range -45 °C - +105 °C

Part No.	D (mm)	D (")	DN	L	H (mm)	s (mm)	F _{a,z} (N)	Pack 1
I250000012	12,0	-	-	50 mm	62.6	25.3	100	25
I250000015	15,0	-	-	50 mm	66.0	25.5	100	25
I250000018	17,2 - 18,0	3/8	10	50 mm	68.6	25.3	100	25
I250000022	21,3 - 22,0	1/2	15	50 mm	75.4	26.7	100	25
I250000028	26,9 - 28,0	3/4	20	50 mm	78.6	25.3	100	25
I250000035	33,7 - 35,0	1	25	50 mm	88.0	26.5	100	25
I250000042	42,4	1 1/4	32	50 mm	100.0	28.8	150	25
I250000048	48,3	1 1/2	40	50 mm	100.1	25.9	225	25
I250000054	54,0	-	-	50 mm	104.6	25.3	225	25
I250000057	57,0	-	-	50 mm	107.6	25.3	225	25
I250000060	60,3	2	50	50 mm	110.9	25.3	350	25
I250000064	64,0	-	-	50 mm	128.6	32.3	350	25
I250000070	70,0	-	-	50 mm	134.6	32.3	425	25
I250000076	76,1	2 1/2	65	50 mm	140.7	32.3	575	25
I250000089	88,9	3	80	50 mm	153.5	32.3	875	25
I250000102	101,6	-	-	50 mm	166.2	32.3	1,000	25
I250000108	108,0	-	-	50 mm	176.0	34.0	1,075	5
I250000114	114,3	4	100	50 mm	178.9	32.3	1,250	5
I250000133	133,0	-	-	100 mm	197.6	32.3	1,475	5
I250000140	139,7	5	125	100 mm	205.1	32.7	1,700	5
I250000160	159,0 - 160,0	-	-	100 mm	224.6	32.3	1,950	5
I250000168	168,3	6	150	100 mm	232.9	32.3	2,125	3
I250000219	219,1	8	200	100 mm	283.7	32.3	3,525	3

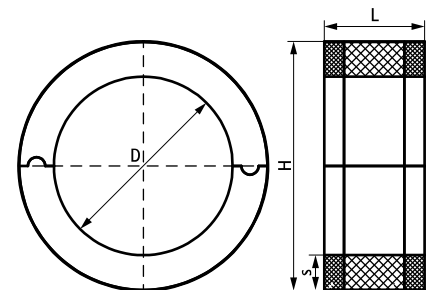

Complementary

- Bifix® G2 (M8/10) (BUP1000)
- 2S Clamp (M8/10)
- BIS Heavy Duty Clamp HD500 (BUP1000)

Complementary

- BIS Heavy Duty Clamp HD500 (BUP1000)