

BISOFIX® E19

(D 03 14)

for insulated pipes 12,0 - 356,0 mm

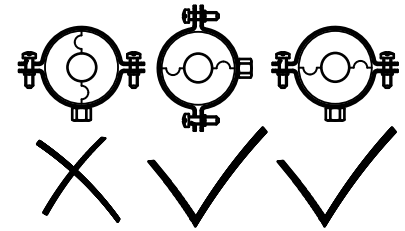

Features and benefits

- for combination with elastomeric foam insulation
- vapourproof glueable with pipe insulation
- does not contain CFC, HCFC, formaldehyde or cadmium
- fire class B2
- PIR density for D <80mm = 80kg/m³
- PIR density for D >80mm = 120kg/m³
- temperature range -45 °C - +105 °C

Part No.	D (mm)	D (")	DN	L	H (mm)	s (mm)	F _{a,z} (N)	Pack 1
I190000012	12,0	-	-	50 mm	50.6	19.3	100	25
I190000015	15,0	-	-	50 mm	54.0	19.5	100	25
I190000018	17,2 - 18,0	3/8	10	50 mm	56.6	19.3	100	25
I190000022	21,3 - 22,0	1/2	15	50 mm	60.6	19.3	100	25
I190000028	26,9 - 28,0	3/4	20	50 mm	66.6	19.3	100	25
I190000035	33,7 - 35,0	1	25	50 mm	74.8	19.9	100	25
I190000042	42,4	1 1/4	32	50 mm	81.0	19.3	150	25
I190000048	48,3	1 1/2	40	50 mm	88.1	19.9	225	25
I190000054	54,0	-	-	50 mm	100.0	23.0	225	25
I190000057	57,0	-	-	50 mm	103.0	23.0	225	25
I190000060	60,3	2	50	50 mm	100.1	19.9	350	25
I190000064	64,0	-	-	50 mm	114.6	25.3	350	25
I190000070	70,0	-	-	50 mm	124.6	27.3	425	25
I190000076	76,1	2 1/2	65	50 mm	126.7	25.3	575	25
I190000089	88,9	3	80	50 mm	139.5	25.3	875	25
I190000102	101,6	-	-	50 mm	152.2	25.3	1,000	25
I190000108	108,0	-	-	50 mm	158.6	25.3	1,075	25
I190000114	114,3	4	100	50 mm	164.9	25.3	1,250	25
I190000133	133,0	-	-	100 mm	192.0	29.5	1,475	5
I190000140	139,7	5	125	100 mm	192.1	26.2	1,700	5
I190000160	159,0 - 160,0	-	-	100 mm	210.6	25.3	1,950	5
I190000168	168,3	6	150	100 mm	218.9	25.3	2,125	5
I190000219	219,1	8	200	100 mm	269.7	25.3	3,525	3
I190000273	273,1	10	250	100 mm	323.6	25.3	3,525	2
I190000324	323,9	12	300	100 mm	374.5	25.3	3,525	5
I190000356	356,0	-	-	100 mm	406.6	25.3	3,525	5

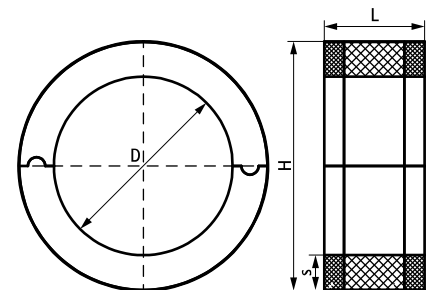

Complementary

- Bifix® G2 (M8/10) (BUP1000)
- 2S Clamp (M8/10)
- BIS Heavy Duty Clamp HD500 (BUP1000)

Complementary

- BIS Heavy Duty Clamp HD500 (BUP1000)