

# BIS Wall Plate CO<sub>2</sub> Welded (BUP1000)

(K 15 09)

fixing to wall or ceiling



## Features and benefits

- fixings to wall, ceiling or floor (tension and bending loads allowed)
- slots at 90° to each other to simplify fixing
- with CO<sub>2</sub> welded connection nut
- material: steel
- surface protection:
  - product is part of the Walraven BIS UltraProtect® 1000 system
  - suitable for in- and outdoor applications
  - stands min. 1,000 hours salt spray test (max. 5% red rust) according to ISO 9227

Part No.	G	L	B	H	s	d1	d2	k	F <sub>a,z</sub>	Pack 1
			(mm)	(mm)	(mm)	(mm)	(mm)	(mm)	(N)	
67198016	M16	145 mm	38	19.5	4	30 x 11	25 x 11	100	6,000	50
67198021	G½"	145 mm	38	21.5	4	30 x 11	25 x 11	100	4,000	50
67198033	G1"	145 mm	38	26.5	4	30 x 11	25 x 11	100	5,500	50

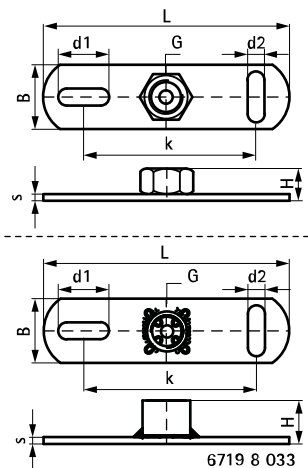

**Complementary**  
BIS Stud Bolt (BUP1000)