

# BIS Heavy Duty Clamp HD500 (BUP1000)

(B 10 06)

for steel pipes 159 - 509 mm

M16



## Features and benefits

- two-part clamp with two locking bolts
- heavy design
- bolts secured with anti-loss washer
- with CO<sub>2</sub> welded connection nut
- material: steel
- surface protection:
  - product is part of the Walraven BIS UltraProtect® 1000 system
  - suitable for in- and outdoor applications
  - stands min. 1,000 hours salt spray test (max. 5% red rust) according to ISO 9227
- tested for fire safety



Part No.	D (mm)	D (°)	DN	G	B (mm)	H (mm)	h (mm)	b x s (mm)	cs	F <sub>a,z</sub> (N)	RAL	Pack 1
33068169	159 - 169	6	150	M16	241	193	103	38 x 4.0	M10	8,200	RAL <sup>1</sup>	15
33068183	173 - 183	-	-	M16	255	207	110	38 x 4.0	M10	8,200	RAL <sup>1</sup>	15
33068202	192 - 202	-	-	M16	274	226	130	38 x 4.0	M10	8,200	RAL <sup>1</sup>	15
33068227	217 - 227	8	200	M16	299	263	144	38 x 4.0	M10	8,200	RAL <sup>1</sup>	2
33068241	229 - 241	-	-	M16	322	277	151	38 x 4.0	M12	8,200	RAL <sup>1</sup>	2
33068254	244 - 254	-	-	M16	335	290	158	38 x 4.0	M12	8,200	RAL <sup>1</sup>	2
33068264	254 - 264	-	-	M16	345	300	163	38 x 4.0	M12	8,200	RAL <sup>1</sup>	2
33068279	267 - 279	10	250	M16	360	315	170	38 x 4.0	M12	8,200	RAL <sup>1</sup>	2
33068289	279 - 289	-	-	M16	367	324	175	48 x 5.0	M12	12,000	RAL <sup>1</sup>	2
33068302	292 - 302	-	-	M16	380	337	181	48 x 5.0	M12	12,000	RAL <sup>1</sup>	2
33068325	315 - 325	12	300	M16	403	358	193	48 x 5.0	M12	12,000	RAL <sup>1</sup>	2
33068360	350 - 360	14	350	M16	439	395	210	48 x 5.0	M12	12,000	RAL <sup>1</sup>	2
33068374	364 - 374	-	-	M16	453	409	217	48 x 5.0	M12	12,000	RAL <sup>1</sup>	2
33068389	379 - 389	-	-	M16	468	424	225	48 x 5.0	M12	12,000	RAL <sup>1</sup>	2
33068408	398 - 408	16	400	M16	487	443	234	48 x 5.0	M12	12,000	RAL <sup>1</sup>	2
33068418	408 - 418	-	-	M16	498	441	227	48 x 5.0	M12	12,000	RAL <sup>1</sup>	2
33068436	424 - 436	-	-	M16	515	471	248	48 x 5.0	M12	12,000	RAL <sup>1</sup>	2
33068458	448 - 458	18	450	M16	537	493	259	48 x 5.0	M12	12,000	RAL <sup>1</sup>	2
33068509	499 - 509	20	500	M16	588	544	285	48 x 5.0	M12	12,000	RAL <sup>1</sup>	2

RAL<sup>1</sup> = tested, certified and monitored by a third party according to RAL-GZ 655/B.

For detailed technical information about our RAL marked products, please see the RAL datasheet in our web catalogue.

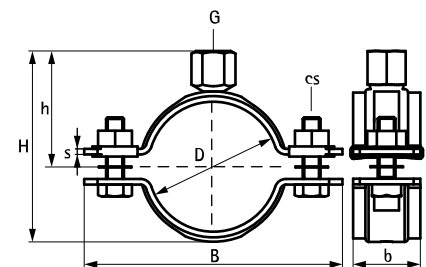

### Complementary

Walraven RapidStrut® Fixing System  
Walraven Fixing Accessories  
Walraven Fastenings

### Complementary

BIS Silicone Profile

### Alternative

BIS Heavy Duty Clamp HD1501 (BUP1000)