



BIS Riser Clamp

- Support and stabilizing of vertical pipe runs
- Perfect for plastic and metal pipe applications



BIS Whisper Riser Pads

- Reduces vibration and noise transfer to building structure
- Reduces corrosion by isolating clamp from floor



BIS Riser Clamp

For metal and plastic pipe

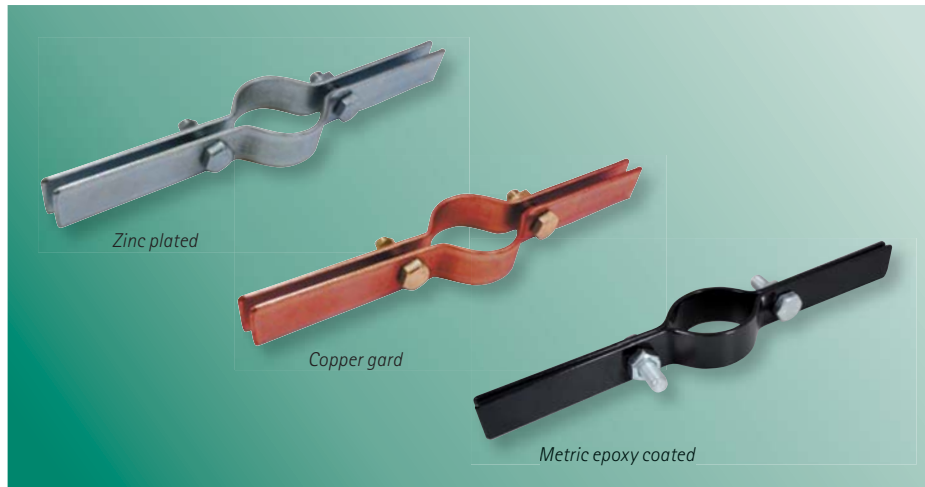

Walraven BIS Riser Clamps are recommended for supporting vertical pipe runs. For Plastic or Metal pipe 3/4" (25 mm) to 10" (250 mm).

BIS Riser Clamp conform with MSS SP58 and SP-69 (Type 8).

BIS Riser Clamps are made of carbon steel and are available in three different coatings:

- Zinc plated for IPS sizes
- Copper gard for CTS sizes
- Metric epoxy coated for Metric sizes



BIS Whisper Riser Pads

Perfect fit to BIS Riser Clamp



Walraven BIS Whisper Riser Pads are made of EPDM rubber and are used to insulate riser clamps from building structure to

minimize noise and vibration transfer. They also prevent corrosion by isolating riser from the floor.

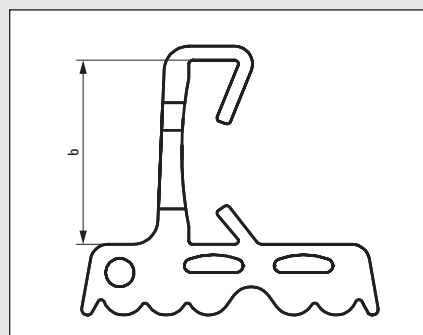

BIS Whisper Riser Pads can be used on most risers up to 8" sizes. Temperature rated up to 250 °F and fire resistant.

Available in 2 sizes for perfect fit.

9737 1 00120
9737 1 00226

BIS Riser Clamp & BIS Whisper Riser Pads

Technical information

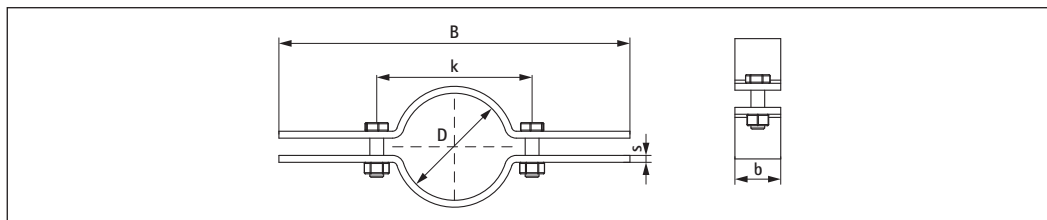

Zinc plated

Part No. Clamp	Part No. incl. Pad	D IPS(")	B (")	b (")	s (ga/")	k (")	Fa,z (lbs)	Box
B497 3 027	B4973028WP	3/4	8 ¹³ / ₁₆	1	8 ga	2 ⁵ / ₁₆	220	25
B497 3 034	B4973032WP	1	9 ¹ / ₁₆	1	8 ga	2 ⁵ / ₈	220	25
B497 3 042	B4973040WP	1 ¹ / ₄	9 ⁷ / ₁₆	1	8 ga	2 ¹⁵ / ₁₆	250	25
B497 3 048	B4973050WP	1 ¹ / ₂	10	1	8 ga	3 ⁷ / ₁₆	250	25
B497 3 060	B4973063WP	2	10 ⁹ / ₁₆	1	8 ga	4	300	25
B497 3 075	B4973075WP	2 ¹ / ₂	11 ¹ / ₈	1	3 ga	4 ⁹ / ₁₆	400	25
B497 3 090	B4973090WP	3	11 ¹³ / ₁₆	1	3 ga	5 ¹ / ₄	500	25
B497 3 106	B4973106WP	3 ¹ / ₂	13	1	3 ga	6	600	25
B497 3 114	B4973110WP	4	13 ⁵ / ₈	1	3 ga	6 ⁵ / ₈	750	20
B497 3 140	B4973140WP	5	14 ¹ / ₈	1 ¹ / ₂	3 ga	7 ⁵ / ₈	1500	10
B497 3 169	B4973169WP	6	15 ³ / ₈	1 ¹ / ₂	3 ga	8 ⁷ / ₈	1600	10
B497 3 227	B4973227WP	8	18 ⁵ / ₈	1 ¹ / ₂	3/8"	12	2500	5
B497 3 275	-	10	21	2	3/8"	14 ¹ / ₂	2500	4

Part No. Pad	b (mm)	b (")
9737 1 00120	25	1
9737 1 00226	40	1 ¹ / ₂

Zinc Approvals: Complies with Manufacturers' Standardization Society MSS SP-58 and SP-69 (Type 8) UL, and cUL Approved (2" through 8") - Mild Steel Only



Copper gard

Part No. Clamp	Part No. incl. Pad	D IPS(")	B (")	b (")	s (ga/")	k (")	Fa,z (lbs)	Box
B497 9 018	B4979018WP	1/2	6 ¹¹ / ₁₆	1	11 ga	1 ¹¹ / ₁₆	225	50
B497 9 023	B4979023WP	3/4	7	1	11 ga	2	225	50
B497 9 030	B4979030WP	1	8 ³ / ₄	1	11 ga	2 ¹ / ₄	250	50
B497 9 035	B4979035WP	1 ¹ / ₄	9	1	11 ga	2 ¹ / ₂	250	50
B497 9 043	B4979043WP	1 ¹ / ₂	9 ³ / ₈	1	1 ga	2 ⁷ / ₈	250	50
B497 9 054	B4979054WP	2	9 ¹⁵ / ₁₆	1	8 ga	3 ³ / ₈	500	25
B497 9 070	B4979070WP	2 ¹ / ₂	10 ¹ / ₂	1	8 ga	4	500	25
B497 9 080	B4979080WP	3	11	1	8 ga	4 ⁷ / ₁₆	500	25
B497 9 092	B4979092WP	3 ¹ / ₂	12 ³ / ₁₆	1 - 1/4	8 ga	5 ¹ / ₈	500	25
B497 9 105	B4979105WP	4	12 ⁵ / ₈	1 - 1/4	8 ga	5 ⁹ / ₁₆	500	25
B497 9 130	B4979130WP	5	14 ¹ / ₈	1 - 1/2	3 ga	7 ¹ / ₈	815	10
B497 9 151	B4979151WP	6	15	1 - 1/2	3 ga	8	815	10

Part No. Pad	b (mm)	b (")
9737 1 00120	25	1
9737 1 00226	40	1 ¹ / ₂

Copper Gard Approvals: Complies with Manufacturers' Standardization Society MSS SP-58 and SP-69 (Type 8)

BIS Riser Clamp & BIS Whisper Riser Pads

Technical information

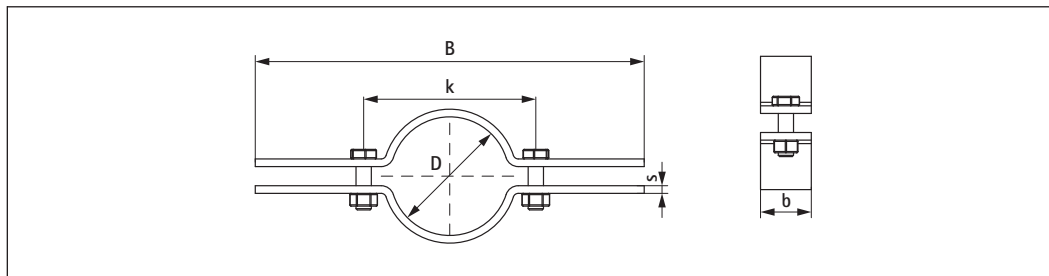

Metric epoxy coated

Part No.	Part No. incl. Pad	D (mm)	Bolt	B (mm)	b (mm)	b (")	s (mm)	k (mm)	Fa,z (lbs)	Bag
B497 6 025	B4976025WP	25	M10 x 30 mm	240	25	1	5	65	250	10
B497 6 032	B4976032WP	32	M10 x 30 mm	245	25	1	5	68	250	10
B497 6 040	B4976040WP	40	M10 x 30 mm	254	25	1	5	86	250	10
B497 6 050	B4976050WP	50	M10 x 30 mm	265	25	1	5	95	250	10
B497 6 063	B4976063WP	63	M10 x 30 mm	275	25	1	5	114	375	10
B497 6 075	B4976075WP	75	M10 x 30 mm	285	25	1	5	116	500	10
B497 6 090	B4976090WP	90	M12 x 40 mm	305	40	1½	6	136	500	10
B497 6 110	B4976110WP	110	M12 x 40 mm	343	40	1½	6	176	800	10
B497 6 125	B4976125WP	125	M12 x 40 mm	370	40	1½	6	210	1050	10
B497 6 160	B4976160WP	160	M12 x 40 mm	395	40	1½	8	228	1450	10
B497 6 200	B4976200WP	200	M16 x 50 mm	470	40	1½	8	297	2300	10
B497 6 250	B4976250WP	250	M16 x 50 mm	530	40	1½	8	371	2500	10

Epoxy Approvals: Complies with Manufacturers' Standardization Society MSS SP-58 and SP-69 (Type 8)

Part No. Pad	b (mm)	b (")
9737 1 00120	25	1
9737 1 00226	40	1½

More Walraven solutions for your projects



BIS RapidStrut® Rail DS 5



BIS RapidRail® System



BISMAT® Flash



W Strut Clamp 2000